

7322 BEM

Angular contact ball bearings, single row

3D View

Interactive 3D graphic, click to activate and rotate

Technical drawings

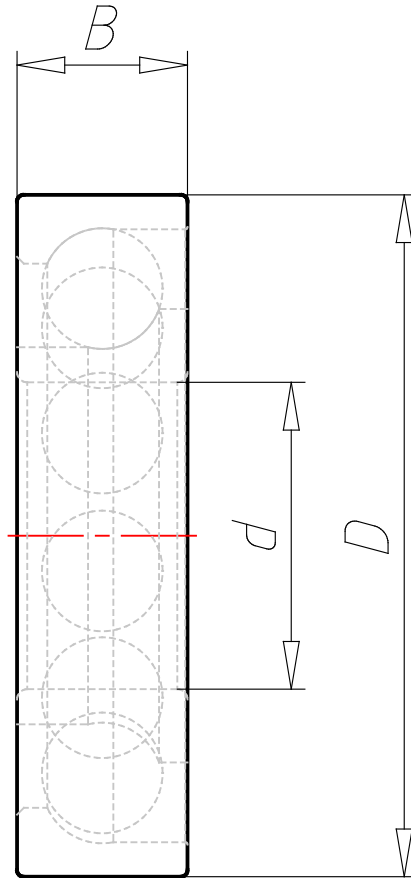

Technical Data

Designation	7322 BEM
d - Bore diameter	110 (mm)
D - Outside diameter	240 (mm)
B - Width	50 (mm)
C - Basic dynamic load rating	225 (kN)
C0 - Basic static load rating	224 (kN)
Pu - Fatigue load limit	7.2 (kN)
Reference speed - Reference speed	3400 (r/min)
Limiting speed - Limiting speed	3400 (r/min)
Designation bearing	7322 BEM